



MODULE 10

MK10-SVMOD-0005
SDS PARTS REFERENCE

Bally Gaming and Systems reserves the right to change specifications without prior notice on any and all parts shown in this module when deemed necessary.

All information contained herein including, but not limited to, illustrations, specifications dimensions and statements is believed to be reliable as of date of publication but the accuracy or completeness thereof is not guaranteed. Bally Gaming and Systems makes no claim or warranties as to the applications of these products or their suitability or fitness for any particular purpose. Neither seller nor manufacturer shall be liable for any injury resulting from the use or inability to use product. Accordingly, it is recommended that each user independently test and evaluate products for their intended use and the user assumes all risk and liability whatsoever in connection therewith.

All rights reserved. The text and illustrations contained in the booklet are property of Bally

**For Customer Service and information:
+1-702-896-7772 Outside the U.S.
1-877-GO-BALLY (877) 462-2559 in the U.S. and Canada
896-7772 in Las Vegas
FAX: +1-702-896-7710
or visit our website at <http://www.ballygaming.com>**



TABLE OF CONTENTS

Overview.....	4
Basic Parts.....	4
<i>GMU.....</i>	<i>5</i>
<i>Faceplates.....</i>	<i>5</i>
<i>Card Reader.....</i>	<i>5</i>
<i>Keypad.....</i>	<i>6</i>
<i>Icon Buttons.....</i>	<i>7</i>
<i>Displays.....</i>	<i>7</i>
<i>SDS CD</i>	<i>7</i>
<i>Documentation.....</i>	<i>7</i>
GameNet Kits	8
<i>GameNet Kit.....</i>	<i>8</i>
<i>Descriptions.....</i>	<i>8</i>
CIU Kits.....	9
<i>CIU Kit.....</i>	<i>9</i>
<i>Descriptions.....</i>	<i>9</i>
Overlay Finish Chart.....	10
DMK Metal Finish Chart.....	10
Kit Part Tables.....	11
<i>Installation.....</i>	<i>11</i>
<i>Kits Table.....</i>	<i>11</i>
<i>Installation</i>	<i>11</i>
<i>Spare Parts.....</i>	<i>11</i>
<i>EPI Upgrade.....</i>	<i>11</i>
<i>Kits Table.....</i>	<i>11</i>
<i>Keypads.....</i>	<i>12</i>
<i>Displays.....</i>	<i>12</i>
Common Parts.....	12
<i>Card Readers.....</i>	<i>12</i>
<i>EPI / DMK Cables.....</i>	<i>12</i>
<i>Level Shifter Kit.....</i>	<i>12</i>
<i>D2E Kits.....</i>	<i>12</i>
EPI.....	13
<i>Part Number Code Description.....</i>	<i>13</i>
<i>EPI Part.....</i>	<i>13</i>
<i>Number Table.....</i>	<i>13</i>
<i>Cable Reference Chart.....</i>	<i>14</i>
Mastercom 250 Components.....	14
Mastercom 220+	17
<i>Cable Chart.....</i>	<i>17</i>
<i>Generic Components.....</i>	<i>17</i>
EPI Assembly - Exploded View.....	18
SDS Kits- United States.....	19
EPI / DMK Component Parts - United States.....	23
EPI / DMK Component Parts - International.....	40
SDS Kits -230V kits for Riverboats.....	40
SDS Kits -Germany.....	41
SDS Kits -New Zealand.....	41



Overview

This manual provides a parts reference for the Bally Gaming and Systems Slot Data Systems (SDS) Enhanced Player Interface (EPI) or Display with Magnetic Card Reader and Keypad (DMK). It provides EPI and DMK information for supported U.S., German and New Zealand manufacturers. Also included are tables of Installation Kit numbers, and Communication Interface Unit (CIU) upgrade kits.

To order an EPI or DMK kit, identify the machine manufacturer and the Model. Select the GMU Kit ID number, and/or the EPI or DMK Kit ID number. Both the EPI and DMK Kits consist of a keypad, display, card reader, bracket, and cable, unless otherwise noted. Bally Gaming & Systems supplies faceplates for Bally and IGT machines only. Bracket overlays are available for Bally, IGT, Williams, and Sigma machines.

EPI kits using an MC220+ require the additional purchase of a Mastercom 220+ Converter, part number K220+EPI-CNVTR. A list of the EPI component parts is included on Page 17.

The DMK kit, K-DMKNEUIM-COMP, the EPI kits K-EPI-000010112 (LCD Display) and the K-EPI-000020112 (VFD Display) are internal mount sub-assemblies. The metalwork for these kits is provided by the manufacturer, except for Bally and IGT. Bally provides the metalwork for these. A D2E is required for operation of a DMK system on a 250 board. The Mastercom 250 replaces any MC220+ using an EPI converter.



NOTE: xxxxxx in EPI Kit ID numbers (e.g. K-EPI304xxxxxx) are generic place holders for specific options. Refer to the EPI Code Description in the References and Notes section for an explanation of the Options, Metal Finish Chart, and Overlay Finish Chart.

For specific options regarding the -YY extension in the Overlay part numbers (e.g. M-R305251-YY) refer to the Overlay Finish Chart.

For specific options regarding the -ZZ extension in the DMK Kit numbers (e.g. K-DMK-205206-ZZ) or Faceplate part numbers (e.g. P-205244-ZZ) refer to the Metal Finish Chart.



NOTE: The DMK product line is no longer supported as a current product. All part numbers and information is given for reference. Most parts are still available for service and spares.

Basic Parts

Illustrated on the following pages are components of an SDS system. Each machine on the system has a Game Monitoring Unit (GMU) with an interface cable for data collection.





The GMU refers to any of the following configurations: Mastercom, Mastercom 220, Mastercom 220+, and Mastercom 250. A variety of programmed EPROMs ensure interface compatibility with the different processors and system server from other manufacturers.

GMU



Faceplates, also called mounting brackets, refer to the metalwork where the player interface components are mounted. The components consist of card readers, icon buttons, keypads, and displays.



Faceplates

This is the front view of the display, keypad, blank, and cardreader components mounted to the faceplate.

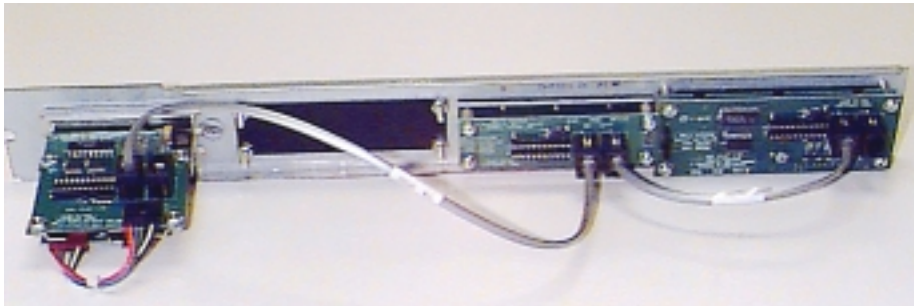

This view illustrates the mounting of components on the faceplate.

Each machine may have an optional player interface to allow the player to collect points for awards, comps, or some other casino promotion. Employee cards allow the casino to restrict and monitor employee access to a machine and monitor functions performed to the machine. Player cards are used to identify the customer playing a particular machine.

Card Reader

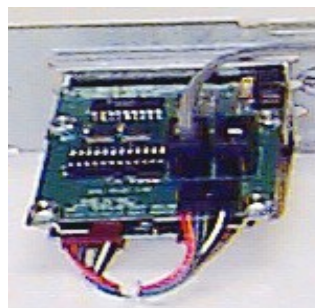
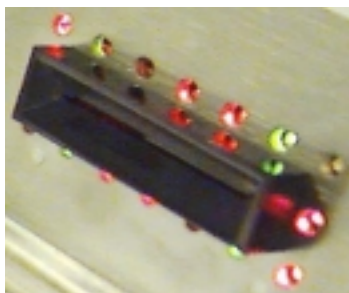

Keypad

There are three types of keypads available. The “2x6” keypad has two rows of six buttons. The “3x4” keypad has four rows of three buttons. The keypad is used for logging service functions, paying jackpots, and processing fills.

2x6 Keypad



*3x4 Keypad
(DMK Only)*



*4x3 Keypad
(EPI Only)*





The optional icon buttons can be used by the player to request cocktails, change, or to reserve the game. They are available only for EPI products.

Icon Buttons



The latest and most popular display is the Vacuum Fluorescent Display (VFD). The VFD offers a better look and versatility over the Liquid Crystal Display (LCD). Both offer dual lines of text.

Displays

VFD

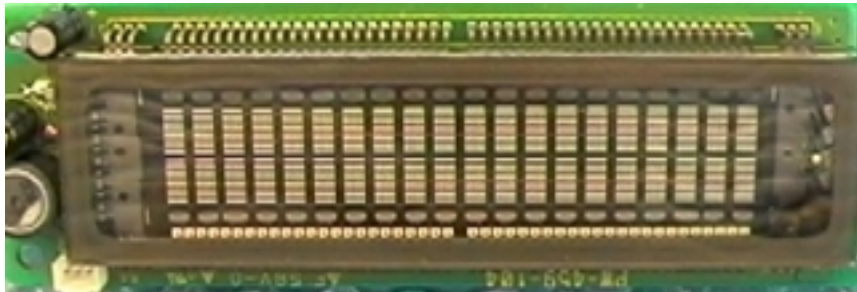

LCD



SDS DOCUMENTATION ON CD	
Software Version	Part Number
7.0	BS-86-0021
7.1	BS-86-0028
8.0	BS-86-0039

SDS CD Documentation



GameNet Kits

GameNet Kits	
K-GAMENET-1K	Assembly, GameNet Rack Complete - 1000 Addresses/400 Slots
K-GAMENET-2K	Assembly, GameNet Rack Complete - 2000 Addresses/800 Slots
K-GAMENET-3K	Assembly, GameNet Rack Complete - 3000 Addresses/1200 Slots
K-GAMENET-4K	Assembly, GameNet Rack Complete - 4000 Addresses/1600 Slots
K-GAMENET-5K	Assembly, GameNet Rack Complete - 5000 Addresses/2000 Slots
K-GAMENET-6K	Assembly, GameNet Rack Complete - 6000 Addresses/2400 Slots
K-GAMENET-7K	Assembly, GameNet Rack Complete - 7000 Addresses/2800 Slots
K-GAMENET-8K	Assembly, GameNet Rack Complete - 8000 Addresses/3200 Slots
K-GAMENETADD1K	Kit, additional 1000 Addresses/400 slots
K-GAMENETEX1K	Kit, add switch rack for additional 1000 Addresses/400slots
K-CABINET-19-44	Cabinet, 19" x 44" -- Black
K-GMNT-CRASHKIT	Kit, GameNet Crash Assemblies K-GAMENET-MON -- Asy, GameNet Monitor Card K-GAMENET-PSU -- Asy, GameNet Power Supply K-GAMENET-SW -- Asy, GameNet Switch
K-GAMENET-SW1K	Asy, GameNet Switch Unit, 1000 Addresses/400 Slots
K-GAMENET-SW2K	Asy, GameNet Switch Unit, 2000 Addresses/800 Slots
K-GAMENET-SW3K	Asy, GameNet Switch Unit, 3000 Addresses/1200 Slots
K-GAMENET-SW4K	Asy, GameNet Switch Unit, 4000 Addresses/4160 Slots
K-GMNT-SLTF SRK	Slotline Fuse Rack

GameNet Kit Descriptions

K-GAMENET-1K through 8K -- Assembly, GameNet Rack Complete - 400 to 3200 Slots - The complete GameNet rack assembly includes all the necessary components needed for a new site GameNet install. Assembly Kit includes patch panels, adapters, an Ethernet Switch, two industrial PCs, an APC-UPS power supply unit, two hostess boards, the GameNet Switch Unit assembly kit, the 19" x 44" cabinet, and all necessary cables, and mounting hardware.

K-GAMENETADD1K -- Kit, Additional 1000 addresses -- The switch upgrade kit includes a patch panel, adapters, two GameNet Switch cards, and cables.

K-GAMENETEX1K -- Kit, add switch rack for additional 1000 addresses -- The switch rack upgrade kit includes all the necessary components to add an additional switch rack, with two GameNet switch cards.

K-CABINET-19-44 -- Cabinet, 19" x 44" -- Black -- The 19" x 44" cabinet is recommended to house all GameNet components.

K-GMNT-CRASHKIT -- Kit, GameNet Crash Assemblies - K-GAMENET-MON -- Asy, GameNet Monitor Card, K-GAMENET-PSU -- Asy, GameNet Power Supply, K-GAMENET-SW -- Asy, GameNet Switch -- The crash kit keeps extra parts on hand for replacement in the event of a failure.

K-GAMENET-SW1K through 4K -- Asy, GameNet Switch Unit, 1000 to 4000 Addresses -- The assembly kit includes all necessary components for a GameNet Switch Unit. This kit includes two switches for every 400 slots, up to eight.





CIU Kits

CIU KITS	
K-906318	Desktop Single Side, No Terminal Switching
K-CIU1000M8D	Basic CIU assembly
K-CIUADD1000M	Additional 1000 machines
K-CIUADD8D	Additional 8 machines
K-CIUEX1000M	Expansion rack for 1000 machines
K-TEREX8D	Terminal / Device expansion rack

K-906318 - Desktop CIU, Single Side - The desktop CIU is designed for use with a single computer (there is no SIU circuitry) and supports a maximum of 1000 machines.

K-CIU1000M8D - Basic CIU Assembly - CIU rack for 1000 machines, 8 devices. Rack includes (1) K-CIUADD1000M and (1) K-CIUADD8D. This is the base / master CIU rack which can support a maximum of 3000 machines and 16 devices. (Support of 3000 machines would require the addition of (2) K-CIUADD1000M and (1) K-CIUADD8D units.)

K-CIUADD1000M - Additional 1000 machines - CIU board kit to add 1000 machine capability to the CIU rack. This kit is for use in K-CIU1000M8D and K-CIUEX1000M racks and consists of the CIU boards and cables necessary to increase the maximum number of machines supported by the CIU by 1000 machines.

K-CIUADD8D - Additional 8 devices - CIU board kit to add support for 8 devices to a CIU rack. This kit is for use in K-CIU1000M8D and K-TEREX8D racks and consists of CIU boards and cable necessary to increase the maximum number of devices the CIU supports by 8 devices.

K-CIUEX1000M - CIU expansion rack equipped for 1000 machines. This rack includes (1) K-CIUADD1000M. This rack is the same basic rack as a K-CIU1000M8D, but it is a slave to the basic rack and allows the system to support an additional 1000 machines. Additional board kits may be added to this rack to support a maximum of 3000 machines and 16 devices. (Support of 3000 machines would require the addition of (2) K-CIUADD1000M and (2) K-CIUADD8D units.) This rack may be used in a K-CIUCABINET or K-CIUCABINET-19 cabinet.

K-TEREX8D - Terminal / device expansion rack equipped for 8 devices. This rack includes (1) K-CIUADD8D. The terminal device expansion CIU rack supports 8 devices and is slave to the K-CIU1000M8D rack. Two (2) additional K-CIUADD8D board kits may be added for a maximum of 24 devices for this rack. This rack may be used in a K-CIUCABINET or K-CIUCABINET-19 cabinet.

G-906318 - Desktop CIU, Single Side - The desktop CIU is designed for use with a single computer (there is no SIU circuitry) and supports a maximum of 1000 machines. This unit is for Europe 220VAC only.

CIU Kit Descriptions



Overlay Finish Chart

For -YY extensions in Overlay part number descriptions (e.g. M-R305251-YY), see the Overlay Finish Chart below for available options.

OVERLAY FINISH CHART - CASINO CODES	
DMK PRODUCTS	EPI PRODUCTS
-01= Standard Bally Product	-01= Standard Bally Product
-02= New York New York	-02= Wild Wild West



- NOTES:
- 1) The standard overlay color is: 01 - Generic
 - 2) -02 overlays are casino-specific. Custom examples are listed above.
 - 3) A Bonus Point Station w/ Mag Card Reader. Assembly number K-906419 is available for Park Place Entertainment casinos only.

DMK Metal Finish Chart

For -zz extensions in the DMK Kit number descriptions, (e.g. K-DMK-205206-zz) and Faceplate part number descriptions, (e.g. P-205224-zz), refer to the DMK Metal Finish Chart below for a description of available colors.

DMK METAL FINISH CHART
-01 = Mirror Stainless -MS = #8 Mirror Stainless
-03 = Bright Gold -PG = Gold Plated Over Titanium Nitrate
-04 = Brushed Gold -BG = Brushed Gold Plated Over Titanium Nitrate
-05 = Black -BK = Black
-06 = White -WT = White
-07 = Sungold -SG = Sungold
-08 = Red -RD = Red
-09 = Gold Vein -GV = Gold Vein





The following tables include the part numbers for Installation Kits, EPI Upgrade Compatible Kits, and CIU Kits.

Kit Part Tables

Installation Kits Table

INSTALLATION KITS		
Part #	Description	Notes
K-220-INS-SINGL	1 machine per base, 1 drop	Use with Belden Cabling
K-250-INS-SINGL		
K-220-INS-DOUBL	2 machines per base, 1 drop	
K-250-INS-DOUBL		
K-250-INS-QUAD	4 machines per base, 2 drops	
K-CAT5-SINGLE	1 machine per base, 1 drop	
K-CAT5-250-SINGL		
K-CAT5-DOUBLE	2 machines per base, 1 drop	
K-CAT5-250-DBL		
K-CAT5-QUAD	4 machines per base, 2 drops	
K-CAT5-250-QUAD		

NOTE: CBL-900046 Fill/Slot Drop Door Cable is used with IGT machines with bill acceptors. It permits the use of an auxiliary switch to detect a machine door or drop door open condition. Bracket number P-89-0006 and switch number E-31-0032 are also required. (These are not required with MC250.)



Installation Spare Parts

DESCRIPTION	PART #	DESCRIPTION	PART #
Beldon/4 Position Slotline PCB - Molex	AS-905792	Beldon/6 Position Slotline PCB - Molex	AS-905797
6 Position Comm. PCB - RJ45 CAT5 250 with protective housing	AS-205265	7' Comm. Cable	CBL-900001
RJ45 to Molex Comm. Cable	CBL-205282	10' Comm. Cable	CBL-900001A
Slotline Testbox	K-TESTBOX	RJ45 to RJ45 Comm. Cable CAT5 250	CBL-205283
Striker (Switch)	P-72-0033	Switch (Drop Door)	E-31-0032
		Bkt. (Switch)	P-09129-A001

EPI UPGRADE COMPATABLE KITS

K-EPI-LCD	K-EPI-KEYPAD2X6
K-EPI-VFD	K-EPI-LED-BEZEL
K-EPI-NEURON	K-EPI-SKEY
K-EPI-CONS	

EPI Upgrade Kits Table



Common Parts

This section will list some of the individual components used in the different machine kits. It includes brackets, faceplates, machine Mastercom™ cables, card readers, cables, D2E kits and displays.

Card Readers

CARD READER		
TYPE	EPI	DMK
Magnetic	AS-75-0021	AS-75-0021
Control Board	AS-205250	n/a
DMK Board	n/a	AS-205107

Keypads

KEYPADS			
TYPE	EPI	DMK	WHERE USED
2 x 6	A-105123	A-105123	All Machine manufacturers, except some Sigma and VLC models
2 x 6	AS-205229	AS-205229	Keypad Controller
2 x 6	AS-105123-01	n/a	EPI Grand equipped machines using K-EPI-751xxxxxx & K-EPI-752xxxxxx
3 x 4	n/a	AS-906417	Sigma models SG1, SG111, SG112 and some VLC models
4 x 3	E-105425	n/a	All IGT EZPay and 17" monitor non-ticket games; also used in EPI component kits
4 x 3	AS-205589	n/a	Keypad Controller

Displays

DISPLAYS		
TYPE	EPI	DMK
LCD	E-21-2418	AS-205106
VFD	AS-205381	n/a

D2E Kits (Refer to the Overview for description information)

D2E KIT	KIT DESCRIPTION
K-D2E-INTRFC-01	To use a DMK reader, with a 2x 6 or 4x 3 keypad, with an MC250 board
K-D2E-INTRFC-02	To use a DMK reader, with a 3 x 4 keypad, with an MC250 board
K-D2E-INTRFC-03	To use a DMK reader, with a 2x 6 or 4x 3 keypad, with the ACSC system
K-D2E-INTRFC-04	To use a DMK reader, with a 3 x 4 keypad, with the ACSC system

EPI / DMK Cables

EPI / DMK TO M/C CABLES	
EPI	DMK
CBL-205293	CBL-906481

Level Shifter Kit

This kit is used to match IGT Serial to Bally Systems simple serial protocol for the MASTERCOM 220+ and 250.

IGT Serial Board Level Shifter Kit	
AS-205536	PCB for K-IGT-LVL-SHFTR Assembly
AS-205539	PCB for K-250-LVL-SHFTR Assembly



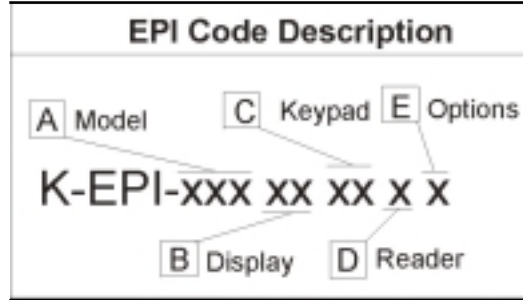

EPI

**Part Number
Code Description**

This figure illustrates the breakdown of an EPI Kit part number. The table below lists EPI kit options. Use this information to identify the EPI kit part number.

NOTE: All configuration combinations may not be available. For example: the Canadian market for Displays (Option B) is 100% LCD (01). Please contact a Bally Customer Service representative for ordering information.



EPI Part Number Table

EPI KIT NUMBERING CHART							
	Mfr.	Code #	Model / Type	Options	Code #	Description	
A	Components Only	000	No Metal Work	DISPLAY B	00	None	
	Bar Tops	BP6	Polished Stainless				
	Bar Tops	BB6	Brushed Stainless				
	Bally	000	All Upright and Slant				
		104	V8000				
	IGT	300	Slant Top	01	LCD		
		301*	S+ IMB Bill Acceptor			02	VFD
		302	S+ Round Top				
		303	Vision Series(Slant Top Only)	00	None		
		304 374	13" Top Box - Black Sun Gold			01	2 x 6 Rubber
		305	Old Upright / Round Top Upright				
		306	Old Style / 2" Narrow S+ Upright	0	None		
		307	17" Monitor GameKing Upright			1	Mag Card
		(IGT) Sierra Design Group only	308	S+ Upright Round Top / Ithica Printer / 2 x 6	0		
			309	Vision Slant Top / Ithica Printer / 2 x 6			
	IGT	311	17" Video Upright EZ PAY / 4x3 Seiko Printer	0	None		
		312	S2000 Vision EZ Pay Upright Round Top				
		314	GameKing plus, EZPay 19.5"				
		356	Old Slant Top Box, 4" deep			1	Icons
	Generic Top Box	750 780	Black Red	2	Lit Bezel		
		EPI Grand	751			Top Mount, Black	3
	752		Side Mount, Black	Sample: K-EPI-302020112			
	OEM Kits	800	Multiple Users/Test Kits	IGT, S+RT, VFD, Mag Rdr, Lit Bezel			
		80G	European Test Kit				



Mastercom 250 Components

MASTERCOM 250 Generic Components	
AS-205463 AS-205462	MC250 Simple Serial MC250 for Bally Games (Metal enclosure and MC250 PCB Assembly included in both)
AS-205268	Assembly, MC250 PCB
AS-36-6507	Power Supply, MC250, 120V
E-26-2940	IC, Flash Memory
CBL-XXXXXX** ** Part Number Based on Manufacturer	Cable, Simple Serial

Cable Reference Chart

MASTERCOM 250 Cable Reference				
Manufacturer	Model	Description	Interface Type	Cable
AC Coin	N/A		Simple Serial	CBL-205506
Anchor Gaming	N/A		Simple Serial	CBL-205323
Aristocrat	N/A		Simple Serial	CBL-205323
Atronics	N/A	Generic-Domestic	Simple Serial	CBL-205323
Aurora	N/A		Simple Serial	CBL-205323
Bally	S5500 Upright	Casino Style ProSlot	Complex Serial	CBL-205324
	S5500	Round Top	Complex Serial	CBL-205324
	S5500/6000	Slant Top	Complex Serial	CBL-205324
	S6000	Upright, 14"	Complex Serial	CBL-205324
	V7000	Game Maker 14" and 20"	Complex Serial	CBL-205325
	V7000	Game Maker Casino Style	Complex Serial	CBL-205325
	V7000	Game Maker Slant Top	Complex Serial	CBL-205325
	V7200	Upright	Complex Serial	CBL-205325
	V7200	Game Maker Slant Top	Complex Serial	CBL-205325
	V8000	Game Magic	Complex Serial	CBL-205325
Bally Ticketing	S6000	Slant Top	SAS	CBL-205324
	S6000	Upright	SAS	CBL-205324
	V7200	Slant Top	SAS	CBL-205325
	V7217/8717	Upright Video	SAS	CBL-205325
	V7219/8719	Upright Video	SAS	CBL-205325
CDS	N/A	Generic-Domestic	Simple Serial	CBL-205540-VIG1 CBL-205541-VIG2
Coinmaster	N/A		Simple Serial	CBL-205323
Eagle/Games of Chance	N/A		Simple Serial	CBL-205323





MASTERCOM 250 Cable Reference (cont.)

Cable Reference Chart (cont)

<i>Manufacturer</i>	<i>Model</i>	<i>Description</i>	<i>Interface Type</i>	<i>Cable</i>	
IGCA	n/a	Generic-Domestic	Simple Serial	CBL-205323	
IGT	S+ Slant Top	3" Player Tracking	Serial	CBL-205323	
		13" Slant Top	Serial	CBL-205323	
	S+ IBA	3" PLayer Tracking/Upright Casino Top	Serial	CBL-205323	
	S+ IBA older	Narrow 2" Player Tracking/Upright	Serial	CBL-205323	
	S+ IBA "I" Series	Upright	Serial	CBL-205506	
	S+ Round Top	2" Tracking Ready	Serial	CBL-205323	
		3" Player Tracking	Serial	CBL-205323	
	PE+ w/ IMB B.A.	Top Box (lock required)	Serial	CBL-205323	
	PE+ Slant Top	3" Player Tracking	Serial	CBL-205323	
		13" Top Box	Serial	CBL-205323	
	Game King Slant Top	3" Player Tracking	Simple Serial	CBL-205506	
		13" Top Box	Simple Serial	CBL-205506	
	13" Video Game King	Generic-Domestic Top Box	Simple Serial	CBL-205506	
	GameKing Upright	17" Monitor	Simple Serial	CBL-205506	
	Vision Series	Upright Square Top	Simple Serial	CBL-205506	
		Slant Top	Simple Serial	CBL-205506	
		Upright Round Top	Simple Serial	CBL-205506	
	Older Games	4" Deep Slant Top	Simple Serial	CBL-205323	
	S+ Jeopardy	Upright Round Top	Serial	CBL-205506	
	S+ Wheel of Fortune	Upright Round Top (3")	Serial	CBL-205323	
		Upright Round Top (1.5")	Serial	CBL-205323	
	S+ "I" Wheel of Fortune	\$0.05 Slant Top Wide Area Progressive	Serial	CBL-205506	
	IGT EZPay	GameKing Upright	17" Monitor	Simple Serial	CBL-205506
		GameKing plus	19.5" with printer	Simple Serial	CBL-205506
		S2000 Vision	19.5" with printer, 4-5 reels	Simple Serial	CBL-205506
	Konami	N/A		Simple Serial	CBL-205575
	Pacific Gaming	N/A		Simple Serial	CBL-205323
	R. Franco	N/A		Simple Serial	CBL-205323
Shufflemaster	N/A		Simple Serial	CBL-205323	



Cable Reference Chart (cont)

MASTERCOM 250 Cable Reference (cont.)				
<i>Manufacturer</i>	<i>Model</i>	<i>Description</i>	<i>Interface Type</i>	<i>Cable</i>
Sigma	SG150, SG300	Upright Reel w/ SIB Board	Simple Serial	CBL-205522
	UV1700, SV1900	Upright Video Slant Video	Simple Serial	CBL-205522
Silicon Gaming	N/A	Generic-Domestic	Simple Serial	CBL-205323
Spielo Gaming	N/A			CBL-205323
Summitt Limited	N/A			CBL-205323
Unidesa	N/A		Simple Serial	CBL-205323
US Games/ Leisure Time	Pot of Gold	Video Poker	Simple Serial	CBL-205573
VLC	N/A		Simple Serial	CBL-205538
Williams	All Models	Upright/Wide Body /Slant Top	Simple Serial	CBL-205515
World Touch Gaming	N/A		Simple Serial	CBL-205323





MASTERCOM 220+ Generic Components	
AS-906491	MC220+Simple Serial Mounting Bracket
K-220C-PLUS	Includes 220 PCB, Piggyback 220+ upgrade PCB, and battery
AS-36-6500	Power Supply, 120V
E-26-2910-1	IC, Flash Memory
CBL-XXXXXX** ** Part Number Based on Manufacturer	Cable, Simple Serial

Mastercom 220+ Generic Components

MASTERCOM 220+ CABLE CHART **For Reference Only**				
Cable #	Manufacturer	Type	Models	K = US G = Germany N = New Zealand
CBL-205310	AC Coin	n/a	n/a	K
CBL-205233	Aristocrat	n/a	All	G
CBL-205184 CBL-205188 CBL-205196 CBL-205337	Aristocrat Serial	n/a	n/a	N
CBL-205184 CBL-205188 CBL-205196 CBL-205421	Aristocrat Slant Top	n/a	All	N
CBL-205130	Bally	V7000 V7200	All	K G N
CBL-900028	Bally	S6000 S5500 S5500	All All Domestic All Europe	K G K G
CBL-205310	IGT	"I" Series Game King 13" Video G.K.	All All Winners Choice	K K K
CBL-900007 CBL-900010	IGT	Pulse	All	K
CBL-205379	Sigma	SG150	Upright	K
CBL-900023	Sigma	Europe	All	G
		PT2, PT4, SG1, SG32, SG50, SG111, SG112	All	K
CBL-900045	Unidesa	n/a	n/a	K
CBL-205202	US Games	n/a	n/a	K
CBL-205211	VLC	n/a	All	K
CBL-205161	Williams	n/a	All	K
CBL-900045	Atronics	n/a	All	K G
	Aristocrat	n/a	All	K
	CDS	n/a	All (includes Cool Millions)	K G
	ICGA	n/a	All	K G
	Silicon Gaming	n/a	All	K
	IGT	Slant Tops S+ w. IBA S+ PE+ Players Choice Dual Scrn Keno Wheel of Fortune	All S+ Upright	K

Cable Chart

EPI Assembly - Exploded View

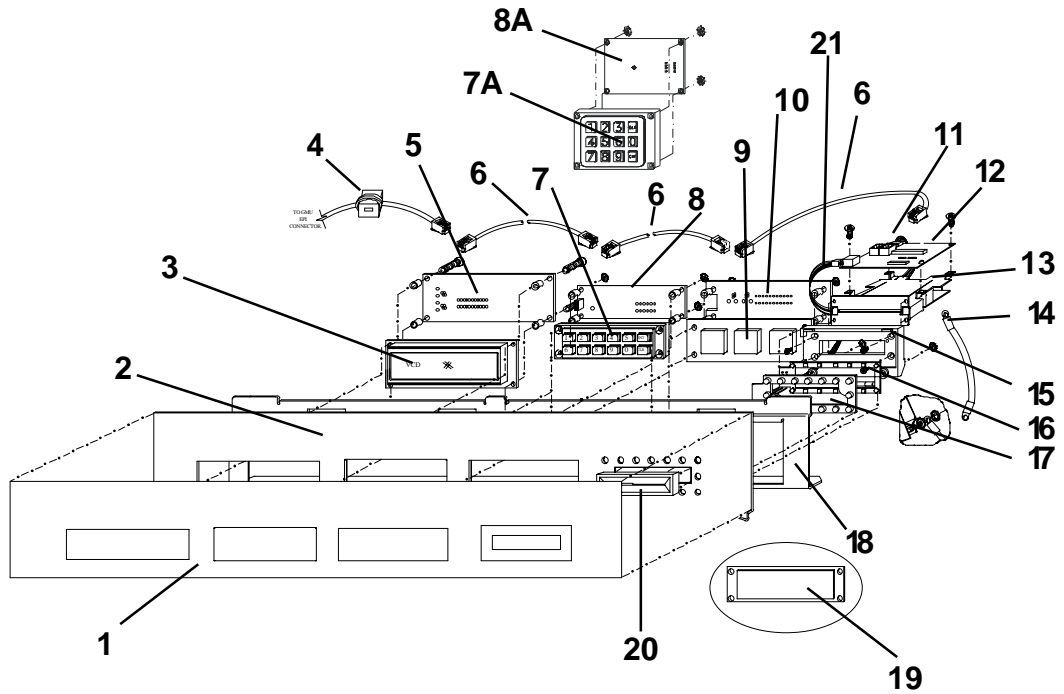

ITEM #	PART NUMBER	DESCRIPTION
1	M-R 305XXX-XX	Overlay
2	(Depends on machine model)	Faceplate, Panel
3	AS-205381	Asy, VFD Display
4	CBL-205293	Cable, EPI to MasterCom
5	AS-205328	Asy, VFD Controller
6	CBL-205265	Cable, RJ11 Male 14"
7	A-105123	Keypad, 2 x 6
7A	E-105425	Keypad, 4 x 3
8	AS-205229	Asy, Keypad Controller
8A	AS-205589	Asy, 4 x 3 Keypad Controller
9	AS-205295	Asy, Icon Membrane Keypad
10	AS-205264	Asy, Icon Controller, EPI
11	CBL-205275	Cable, Reader to Controller
12	AS-205250	Asy, Mag Reader Controller
13	AS-75-0021	Asy, Reader, Magnetic
14	E-205336	Ground Strap
15	M-105329	Bracket, Reader Mounting
16	AS-205251	Asy, LED Display
17	M-105328	Lightguide, EPI
18	(Depends on machine model)	Bracket, Panel
19	M-105357	Cover, Icon Blanking
20	M-71-0003	Bezel, Reader
21	CBL-205276	Cable, To Neuron Bezel Assy.



SDS Kits- United States

SDS KITS - PRODUCT REFERENCE LIST - UNITED STATES						
Machine Manufacturer	Model	Description	Mastercom/ GMU	EPI Reader ID #	DMK Reader ID #	Notes
AC Coin	n/a	?	K-250-GAMEKING	K-EPI-302xxxxxx	n/a	"Slotopoly"
Anchor Gaming	n/a	n/a	K-250-SIMPL-SER	K-EPI-000xxxxxx	n/a	Mfr. supplies metal work
Aristocrat	n/a	Simple Serial	K-220+SIMPL-SER K-250-SIMPL-SER	K-EPI-000xxxxxx	K-DMKNEUIM-COMP	1) Mfr. supplies metal work; 2) SPC can be purchased from Mfr. to make the simple serial
Atronics	n/a	Generic / Domestic	K-220+SIMPL-SER K-250-SIMPL-SER	K-EPI-000xxxxxx	K-DMKNEUIM-COMP	Mfr. supplies metal work
Aurora	n/a	n/a	K-250-SIMPL-SER	K-EPI-000xxxxxx	n/a	Mfr. supplies metal work
Bally	S6000	Slim Line	K-220+BAL-S5500 K-250-BAL-S5500	K-EPI-000xxxxxx	n/a	Top Box
Bally	V7200	Slim Line	K-220+BAL-V7000 K-250-BAL-V7000	K-EPI-000xxxxxx	n/a	Top Box
Bally	S5500	Upright ProSlot	K-220+BAL-S5500 K-250-BAL-S5500	K-EPI-000xxxxxx	K-DMKNEUIM-COMP	
Bally	S5500 / S6000	Slant Top	K-220+BAL-S5500 K-250-BAL-S5500	K-EPI-000xxxxxx		
Bally	S5500	Round Top	K-220+BAL-S5500 K-250-BAL-S5500	K-EPI-000xxxxxx		
Bally	S6000	Upright	K-220+BAL-S5500 K-250-BAL-S5500	K-EPI-000xxxxxx	K-DMKNEUIM-COMP	
Bally	V7000	Upright / Slant	K-220+BAL-V7000 K-250-BAL-V7000	K-EPI-000xxxxxx	K-DMKNEUIM-COMP	
Bally	V7000	14" or 20" / EPI or DMK / Top Box	K-220+BAL-V7000 K-250-BAL-V7000	K-EPI-000xxxxxx	K-DMKNEUIM-COMP	
Bally	V7000	14" or 20" / Top Box / Older Models	K-220+BAL-V7000 K-250-BAL-V7000	K-EPI-000xxxxxx	K-DMKNEUIM-COMP	SASY DMK parts - obsolete
Bally	V7200	Upright / Slant	K-220+BAL-V7000 K-250-BAL-V7000	K-EPI-000xxxxxx	K-DMKNEUIM-COMP	Req's pigtail (CBL-20238-0001)
Bally	V8000	Upright	K-220+BAL-V7000 K-250-BAL-V7000	K-EPI-000xxxxxx	K-DMKNEUIM-COMP	
Bally	S6000	Slant	K-250-BAL-S5500	K-EPI-000xxxxxx	n/a	Bally Ticketing
Bally	S6000	Upright	K-250-BAL-S5500	K-EPI-000xxxxxx	n/a	Bally Ticketing
Bally	V7200	Slant	K-250-BAL-V7000	K-EPI-000xxxxxx	n/a	Bally Ticketing
Bally	V8717	Upright Video	K-250-BAL-V7000	K-EPI-000xxxxxx	n/a	Bally Ticketing
Bally	V8719	Upright Video	K-250-BAL-V7000	K-EPI-000xxxxxx	n/a	Bally Ticketing
CDS	n/a	Generic / Domestic	K-220+SIMPL-SER K-250-CDS-VIG1* K-250-CDS-VIG2**	K-EPI-000xxxxxx	K-DMKNEUIM-COMP	Mfr. supplies metal work
CDS	n/a	Cool Millions	K-220-SIGMA (NO 250)	K-EPI-000xxxxxx	K-DMKNEUIM-COMP	1) Mfr. supplies metal work 2) Sigma base game
Coinmaster	n/a	n/a	K-250-SIMPL-SER	K-EPI-000xxxxxx	n/a	Mfr. supplies metal work
Eagle/Games of Chance	n/a	n/a	K-250-SIMPL-SER	K-EPI-000xxxxxx	n/a	Mfr. supplies metal work

*VIG1 is used in older CDS games and is identified on the Backplane.

**VIG2 is used in newer CDS games and is identified on the Backplane.



**SDS Kits-
United States
(cont.)**

SDS KITS - PRODUCT REFERENCE LIST - UNITED STATES						
Machine Manufacturer	Model	Description	MASTERCOM/GMU	EPI Reader ID#	DMK Reader ID#	Notes
IGCA	n/a	Generic/ Domestic/ Serial	K-220+SIMPL-SER K-250-SIMPL-SER	K-EPI-000xxxxxx	n/a	Mfr. supplies metal work
IGCA	n/a	Pulse	K-220+IGT-PULSE	K-EPI-000xxxxxx	n/a	1) Mfr. supplies metal work 2) Sigma base game
Konami	n/a		K-250-KONAMI	K-EPI-000020212	n/a	4x3 keypad
Pacific Gaming	n/a	n/a	K-250-SIMPL-SER	K-EPI-000xxxxxx	n/a	Mfr. supplies metal work
R. Franco	n/a	n/a	K-250-SIMPL-SER	K-EPI-000xxxxxx	n/a	Mfr. supplies metal work
Sigma	SG150 SG300	Upright Reel with SIB Board (Serial)	K-220+SIG-SIMPL K-250-SIGMA	K-EPI-000xxxxxx	K-DMKNEUIM-COMP	ie: Yahtzee
Sigma	UV1700 SV1900	Upright Video Slant Video	K-250-SIGMA	K-EPI-000xxxxxx	n/a	Mfr. supplies metal work
Sigma	PT2, PT4, SG32, SG50	(clock/data)	K-220+SIGMA (NO 250)	K-EPI-000xxxxxx	K-DMKNEUIM-COMP	
Sigma	SG1, SG111, SG112	(clock/data)	K-220+SIGMA (NO 250)	K-EPI-000xxxxxx	K-DMKNEU-SIG	
Silicon Gaming	n/a	Generic/ Domestic	k-220+SIMPL-SER	K-EPI-000xxxxxx	K-DMKNEUIM-COMP	Mfr. supplies metal work
Spielo Gaming	n/a	n/a	K-250-SIMPL-SER	K-EPI-000xxxxxx	n/a	Mfr. supplies metal work
Summit Limited	n/a	n/a	K-250-SIMPL-SER	K-EPI-000xxxxxx	n/a	Mfr. supplies metal work
Unidesa	n/a	Simple Serial	K-250-SIMPL-SER	K-EPI-000xxxxxx	n/a	Mfr. supplies metal work
Universal	n/a	(clock/data)	K-220+UNIVERSAL	K-EPI-000xxxxxx	K-DMKNEUIM-COMP	Mfr. supplies metal work
Universal	n/a	Simple Serial	TBD	TBD	TBD	Mfr. supplies metal work
US Games	n/a	Generic/ Domestic/ Video Poker	K-220+USGAMES	K-EPI-000xxxxxx	n/a	Mfr. supplies metal work
		Liesure Time Games/ Pot of Gold	K-250-LTG-POG			
VLC	n/a	n/a	K-220+VLC-SER K-250-VLC-SR	K-EPI-000xxxxxx	K-DMKNEU-SIG	Mfr. supplies metal work
Williams	All Models	Upright/Slant	K-220+WILLIAMS K-250-WILLIAMS	K-EPI-000xxxxxx	K-DMKNEUIM-COMP	Mfr. supplies metal work
World Touch Gaming	n/a	n/a	K-250-SIMPL-SER	K-EPI-000xxxxxx	n/a	Mfr. supplies metal work





**SDS Kits-
United States
(cont.)**

SDS KITS - PRODUCT REFERENCE LIST - UNITED STATES (cont.)						
Machine Manufacturer	Model	Description	Mastercom / GMU	EPI Reader ID #	DMK Reader ID #	Notes
IGT	S-Plus Slant Top	3" Player Tracking	K-220+SIMPL-SER K-250-SIMPL-SER	K-EPI-300xxxxxx	K-DMK-205206-zz	
IGT	S-Plus Slant Top	1.5" Sandwich Design	K-220+SIMPL-SER K-250-SIMPL-SER	none	K-DMK-205171-zz	Use's 13" Top Box
IGT	S-Plus Slant Top	Ramsey Design (IPT)	K-220+SIMPL-SER K-250-SIMPL-SER	none	K-DMK-205172-zz	Use's 13" Top Box
IGT	S-Plus Slant Top	13" Top Box	K-220+SIMPL-SER K-250-SIMPL-SER	K-EPI-304xxxxxx	K-DMK-205353-zz	
IGT	S-Plus IBA , new games post 10/97	3" Player Tracking / Upright Casino	K-220+SIMPL-SER K-250-SIMPL-SER	K-EPI-301xxxxxx* *Replaced by 302	K-DMK-205207-zz	
IGT	S-Plus IBA Upright, older games	Narrow (2") Player Tracking	K-220+SIMPL-SER K-250-SIMPL-SER	K-EPI-306xxxxxx	K-DMK-205142-zz	Internal mount - base of top glass
IGT	S-Plus IBA , "I" Series	Upright, uses Round Top brkt	K-220+IGT-GK K-250-GAMEKING	K-EPI-302xxxxxx	K-DMK-205208-zz	Uses new 1960 circuit board
IGT	S-Plus Round Top	2" Player Tracking	K-220+SIMPL-SER K-250-SIMPL-SER	K-EPI-305xxxxxx	K-DMK-205143-zz	Old style game
IGT	S-Plus Round Top post 10/97	3" Player Tracking	K-220+SIMPL-SER K-250-SIMPL-SER	K-EPI-302xxxxxx	K-DMK-205208-zz	
IGT	Players Edge Plus / with IMB Bill Acceptor	Player Tracking ready, 19.25" top glass	K-220+SIMPL-SER K-250-SIMPL-SER	none	K-DMK-205141-zz	No EPI support
IGT	Players Edge Plus / with IMB Bill Acceptor	Top Box (lock required)	K-220+SIMPL-SER K-250-SIMPL-SER	Black K-EPI-750xxxxxx Red K-EPI-780xxxxxx	K-DMK-205352-zz	
IGT	Players Edge Plus / Slant Top	3" Player Tracking	K-220+SIMPL-SER K-250-SIMPL-SER	K-EPI-300xxxxxx	K-DMK-205206-zz	
IGT	Players Edge Plus / Slant Top	1.5" Sandwich Design	K-220+SIMPL-SER K-250-SIMPL-SER	none	K-DMK-205171-zz	Use's 13" Top Box
IGT	Players Edge Plus Slant Top	Ramsey Design (IPT)	K-220+SIMPL-SER K-250-SIMPL-SER	none	K-DMK-205172-zz	Use 13" Top Box
IGT	Players Edge Plus Slant Top	13" Top Box (lock required)	K-220+IGT-GK K-250-GAMEKING	K-EPI-304xxxxxx	K-DMK-205353-zz	
IGT	GameKing Slant Top	1.5" Sandwich Design	K-220+IGT-GK K-250-GAMEKING	K-EPI-304xxxxxx	K-DMK-205171-zz	Use 13" Top Box
IGT	GameKing Slant Top	3" Player Tracking	K-220+IGT-GK K-250-GAMEKING	K-EPI-300xxxxxx	K-DMK-205206-zz	
IGT	GameKing Slant Top	Ramsey Design (IPT)	K-220+IGT-GK K-250-GAMEKING	K-EPI-304xxxxxx	K-DMK-205172-zz	Use 13" Top Box
IGT	GameKing Slant Top	13" Top Box (Lock Required)	K-220+IGT-GK K-250-GAMEKING	K-EPI-304xxxxxx	K-DMK-205353-zz	
IGT	13" Video GameKing (Winner's Choice)	Keypad ready, in top glass	K-220+IGT-GK K-250-GAMEKING	none	K-DMK-205352-zz	no longer in use
IGT	13" Video GameKing (Winner's Choice)	Generic/ Domestic Top Box	K-220+IGT-GK K-250-GAMEKING	Black K-EPI-750-xxxxxx Red K-EPI-780-xxxxxx	K-DMK-205352-zz	

NOTE: Universal models with a pulse or serial interface do not have a Mastercom harness. These require a "piggyback" board, part number: AS-906474.





**SDS Kits-
United States
(cont.)**

SDS KITS - PRODUCT REFERENCE LIST - UNITED STATES (cont.)						
Machine Manufacturer	Model	Description	Mastercomm / GMU	EPI Reader ID #	DMK Reader ID #	Notes
IGT	17" Monitor GameKing	Upright 4 x 3 Keypad	K-220+IGT-GK K-250-GAMEKING	K-EPI-307020212 K-EPI-307020213	none	w/o ICONS w ICONS
IGT	17" Monitor GameKing	Upright 4 x 3 Keypad	K-220+IGT-GK K-250-GAMEKING	K-EPI-311020212	none	EZPAY
IGT	19" Video GameKing (Winners Choice)		K-220+IGT-GK K-250-GAMEKING	K-EPI-302xxxxxx	K-DMK-205208-zz	
IGT	19" Video GameKing (Winners Choice)	Ithaca with SDG Printer	K-220+IGT-GK K-250-GAMEKING	K-EPI-308xxxxxx	none	
IGT	Twin Top Slant Top	1.5" Sandwich Bracket	K-220+SIMPL-SER K-250-SIMPL-SER	none	K-DMK-205177-zz	
IGT	Twin Top Slant Top	Ramsey Design (IPT)	K-220+SIMPL-SER K-250-SIMPL-SER	none	K-DMK-205171-zz	
IGT	Players Choice	Large Screen Classic	K-220+SIMPL-SER K-250-SIMPL-SER	none	K-DMK-205142-zz	MC250 requires D2E
IGT	Dual Screen Keno	Upright	K-220+SIMPL-SER K-250-SIMPL-SER	none	K-DMK-205289-zz	
IGT	All Models	Pulse Width Outputs	K-220+IGT-PULSE	none	(?)	
IGT	Vision Series Square Top	Upright	K-220+IGT-GK K-250-GAMEKING	K-EPI-302xxxxxx	K-DMK-205208-zz	
IGT	Vision Series Slant Top	Slant Top	K-220+IGT-GK K-250-GAMEKING	K-EPI-303xxxxxx	n/a	Lexus - "Adams Family"
IGT	Vision Series Slant Top	Ithaca with SDG Printer	K-220+IGT-GK K-250-GAMEKING	K-EPI-309xxxxxx	n/a	
IGT	Vision Series Round Top	Upright	K-220+IGT-GK K-250-GAMEKING	K-EPI-302xxxxxx	K-DMK-205208-zz	
IGT	Slant Top (Older Games)	4" - Deep Slant Tops	K-220+SIMPL-SER K-250-SIMPL-SER	K-EPI-356xxxxxx	K-DMK-205445-zz	
IGT	S-Plus Upright Round Top		K-220+IGT-GK K-250-GAMEKING	K-EPI-302xxxxxx	K-DMK-205208-zz	ie: Jeopardy
IGT	S-Plus Upright Round Top	3" Player Tracking	K-220+SIMPL-SER K-250-SIMPL-SER	K-EPI-302xxxxxx	K-DMK-205208-zz	Wheel of Fortune
IGT	S-Plus "I" Slant WAP; Vision Series EPI	WAP Slant	K-220+IGT-GK K-250-GAMEKING	K-EPI-303xxxxxx	n/a	Wheel of Fortune
IGT	S-Plus Upright Round Top	1.5" Player Tracking	K-220+SIMPL-SER K-250-SIMPL-SER	K-EPI-305xxxxxx	K-DMK-205143-zz	Wheel of Fortune
IGT	S2000 Vision	19.5" width, 4-5 Reels	K-250-GAMEKING	K-EPI-312020212	n/a	EZPay
IGT	GameKing Plus	19.5" Upright	K-250-GAMEKING	K-EPI-314020212	n/a	EZPay with Monitor Mask





**EPI / DMK
Component
Parts - United
States**

Manufacturer	Model	Part Name	EPI	DMK
Description				
AC COIN	n/a		K-EPI-302xxxxx	n/a
		Cable MC220+	CBL-205310	
		Cable MC250	CBL-205506	
		Mtg. Bracket	P-105276	n/a
		Faceplate	P-105352-02	
		Overlay	M-R305396-YY	
		220+ Converter	K-220+EPI-CNVTR	
Anchor	n/a		K-EPI-000xxxxx	n/a
		Cable MC220+	n/a	
		Cable MC250	CBL-205323	
		220+ Converter	n/a	n/a
Aristocrat	n/a		K-EPI-000xxxxx	K-DMKNEUM-COMP
Simple Serial (Preferred Version)				
		Cable MC220+	CBL-900045	
		Cable MC250	CBL-205323	
		220+ Converter	K-220+EPI-CNVTR	n/a
Atronics	n/a		K-EPI-000xxxxx	n/a
Generic - Domestic				
		Cable MC220+	CBL-900045	
		Cable MC250	CBL-205323	
		220+ Converter	K-220+EPI-CNVTR	n/a
Aurora	n/a		K-EPI-000xxxxx	n/a
		Cable MC220+	n/a	
		Cable MC250	CBL-205323	
		220+ Converter	n/a	n/a



**EPI / DMK
Component Parts -
United States (cont.)**

Manufacturer	Model	Part Name	EPI	DMK
Description				
Bally	S5500 Upright		K-EPI-000xxxxxx	K-DMKNEUIM-COMP
Casino Style ProSlot				
		Bracket	P-08600-S605	P-08517-SERIES
		Faceplate	P-08600-S604	
		Overlay	M-R305270-YY	
		Hardware Kit*	K-00702-0881	
		Cable MC220+	CBL-900028	
		Cable MC250	CBL-205324	
		220+ Converter	K-220+EPI-CNVTR	n/a
Bally	S5500		K-EPI-000xxxxxx	n/a
Round Top				
These parts are available with mounting hardware in kit # K-00702-0891		Bracket	P-09322-0248	n/a
		Faceplate	P-08577-0001	n/a
		Overlay	M-R0617-0241	n/a
		Hardware Kit*	K-00702-0881	
		Cable MC220+	CBL-900028	
		Cable MC250	CBL-205324	
		220+ Converter	K-220+EPI-CNVTR	n/a
Bally	S5500 / S6000		K-EPI-000xxxxxx	K-DMKNEUIM-COMP
Slant Top				
		Bracket	A-04487-0002	A-04487-0002
		Overlay	M-R305267-YY	M-R0617-0570
		Hardware Kit*	K-00756-0024	
S5500 and S6000		Cable MC220+	CBL-900028	
S5500 and S6000		Cable MC250	CBL-205324	
S6000 must use interface cable			CBL-20234-0001	
		220+ Converter	K-220+EPI-CNVTR	n/a
Bally	S6000		K-EPI-000xxxxxx	K-DMKNEUIM-COMP
Upright				
		Bracket	P-08600-S605	P-08600-S611
Casino Top		Faceplate	P-08600-S604	P-08600-S610
Round Top		Faceplate	P-08600-S603	P-08600-S609
		Overlay	M-R305270-YY	M-R0617-0517
		Hardware Kit*	K-01702-0004	
		Cable MC220+	CBL-900028	
		Cable MC250	CBL-205324	
S6000 must use interface cable			CBL-20234-0001	
		220+ Converter	K-220+EPI-CNVTR	n/a

*Bally Hardware kits include Faceplate, Bracket, Overlay, and mounting hardware.





**EPI / DMK
Component Parts -
United States (cont.)**

Manufacturer	Model	Part Name	EPI	DMK
Description				
Bally	S6000		K-EPI-000xxxxx	n/a
Slant, Bally Ticketing				
		Bracket	P-09319-0575	n/a
		Faceplate	P-09322-0334	n/a
		Hardware Kit*	K-00796-0001	
		Cable MC250	CBL-205324	
Bally	S6000		K-EPI-000xxxxx	n/a
Upright, Bally Ticketing				
		Bracket	P-09322-0333	n/a
		Faceplate	P-09322-0334	n/a
		Hardware Kit*	K-00794-0007	
		Cable MC250	CBL-205324	
Bally	S6000/ S7200	Slim Line	K-EPI-000xxxxx	n/a
Upright - Top Box AS-02110-1030				
These 3 parts can be ordered as Hardware Kit K-01725-0003		Panel	P-08600-V702	n/a
		Adapter Plate	P-09339-0040	
		Overlay	M-R0617-0512	
S6000 V7200		Cable MC220+	CBL-900028 CBL-205130	
S6000 V7200		Cable MC250	CBL-205324 CBL-205325	
S6000 must use interface cable			CBL-20234-0001	
V7200 must use interface cable			CBL-20238-0001	
		220+ Converter	K-220+EPI-CNVTR	n/a
Bally	V7000		K-EPI-000xxxxx	K-DMKNEUM-COMP
Game Maker Casino Style				
		Bracket	P-08600-FF06	P-08600-FF16
		Overlay	M-R305266-YY	M-R305266-YY
		Hardware Kit*	K-01718-0006	
		Cable MC220+	CBL-205130	
		Cable MC250	CBL-205325	
		220+ Converter	K-220+EPI-CNVTR	n/a

*Bally Hardware kits include Faceplate, Bracket, Overlay, and mounting hardware.



**EPI / DMK
Component Parts -
United States (cont.)**

Manufacturer	Model	Part Name	EPI	DMK
Description				
Bally	V7000		K-EPI-000xxxxx	K-DMKNEUIM-COMP
Game Maker 14" & 20" Models				
Fits Top Box A-04525-0030 and Bezel A-04526-000x		Bracket	P-08576-0002	P-08576-0003
		Overlay	M-R305266-YY	M-R305266-YY
		Cable MC220+	CBL-205130	
		Cable MC250	CBL-205325	
		220+ Converter	K-220+EPI-CNVTR	n/a
Bally	V7000		n/a	K-DMKNEUIM-COMP
Game Maker - 14" & 20" older Models - SASY DMK parts obsolete				
		Bracket	n/a	P-08517-0003
		Overlay	n/a	M-R305248-YY
		Cable MC220+	n/a	CBL-205130
		220+ Converter	n/a	n/a
Bally	V7000		K-EPI-000xxxxx	K-DMKNEUIM-COMP
Game Maker Slant Top				
		Bracket	A-04487-0002	A-04480-0002
		Overlay	M-R305267-YY	M-R0617-0570
		Hardware Kit*	K-00756-0024	
		Cable MC220+	CBL-205130	
		Cable MC250	CBL-205325	
		220+ Converter	K-220+EPI-CNVTR	n/a
Bally	V7200		K-EPI-000xxxxx	K-DMKNEUIM-COMP
Upright				
		Bracket	P-08576-0002	P-08576-0003
		Overlay	M-R0617-0586	
		Hardware Kit*	K-00718-0060	
Must use with interface cable (CBL-20238-0001)		Cable MC220+	CBL-205130	
		Cable MC250	CBL-205325	
		220+ Converter	K-220+EPI-CNVTR	n/a

*Bally Hardware kits include Faceplate, Bracket, Overlay, and mounting hardware.





**EPI / DMK
Component Parts -
United States (cont.)**

Manufacturer	Model	Part Name	EPI	DMK
Description				
Bally	V7200		K-EPI-000xxxxxx	K-DMKNEUIM-COMP
Game Maker Slant Top				
		Bracket	A-04487-0002	A-04480-0002
Non LED Reader		Overlay	M-R0617-0243	M-R0617-0570
LED Reader			M-R0617-0246	
		Hardware Kit*	K-00756-0024	
Must use with interface cable (CBL-20238-0001)		Cable MC220+	CBL-205130	
		Cable MC250	CBL-205325	
		220+ Converter	K-220+EPI-CNVTR	n/a
Bally	V7200		K-EPI-000xxxxxx	n/a
Slant, Bally Ticketing				
		Bracket	P-09322-0333	n/a
		Faceplate	P-09322-0334	n/a
		Hardware Kit*	K-00797-0001	
		Cable MC250	CBL-205325	
Bally	V8000		K-EPI-000xxxxxx	K-DMKNEUIM-COMP
Game Magic				
Top Box Fits Top Box A-24503-0030 and Bezel A-24505-00Px		Bracket	P-08600-V702	
"In Door"		Bracket	P-08600-V801	
		Hardware Kit*	K-01718-1002	
		Cable MC220+	CBL-205130	
		Cable MC250	CBL-205325	
		220+ Converter	K-220+EPI-CNVTR	n/a
Bally	V7217/ V8717		K-EPI-000xxxxxx	n/a
Upright Video				
		Bracket	P-09322-0333	n/a
		Faceplate	P-09322-0350	n/a
		Hardware Kit*	K-00798-0006	
		Cable MC250	CBL-205325	
Bally	V7217/ V8717		K-EPI-000xxxxxx	n/a
Upright Video/Bally Ticketing				
		Bracket	P-09322-0333	n/a
		Faceplate	P-09322-0350	n/a
		Hardware Kit*	K-00798-5003	
		Cable MC250	CBL-205325	

*Bally Hardware kits include Faceplate, Bracket, Overlay, and mounting hardware.



**EPI / DMK
Component Parts -
United States (cont.)**

Manufacturer	Model	Part Name	EPI	DMK
Description				
Bally	V7219/ V8719		K-EPI-000xxxxxx	n/a
Upright Video				
		Bracket	P-09322-0333	n/a
		Faceplate	P-09322-0350	n/a
		Hardware Kit*	K-00798-0006	
		Cable MC250	CBL-205325	
Bally	V7219/ V8719		K-EPI-000xxxxxx	n/a
Upright Video/Bally Ticketing				
		Bracket	P-09322-0333	n/a
		Faceplate	P-09322-0350	n/a
		Hardware Kit*	K-00798-5003	
		Cable MC250	CBL-205325	
CDS	n/a		K-EPI-000xxxxxx	K-DMK-NEUIM-COMP
Generic / Domestic				
		Cable MC220+	CBL-900045	
VIG1 used in older games and VIG2 used in newer games		Cable MC250	CBL-205540 = VIG1* CBL-205541 = VIG2**	
		220+ Converter	K-220+EPI-CNVTR	n/a
CDS	(Sigma)		K-EPI-000xxxxxx	K-DMKNEUIM-COMP
Cool Millions				
		Cable MC220+	CBL-900023	
		Cable MC250	n/a	
		Piggyback Board	AS-906518	
		220+ Converter	K-220+EPI-CNVTR	n/a
Coinmaster	n/a		K-EPI-000xxxxxx	n/a
		Cable MC220+	n/a	
		Cable MC250	CBL-205323	
		220+ Converter	n/a	n/a

*Bally Hardware kits include Faceplate, Bracket, Overlay, and mounting hardware.





**EPI / DMK
Component Parts -
United States (cont.)**

Manufacturer	Model	Part Name	EPI	DMK
Description				
Eagle/Games of Chance	n/a		K-EPI-000xxxxxx	n/a
		Cable MC220+	n/a	
		Cable MC250	CBL-205323	
		220+ Converter	n/a	n/a
IGCA	n/a		K-EPI-000xxxxxx	n/a
Generic / Domestic				
EPI Grand (Top Mount)		Cable MC220+	CBL-900045	
		Cable MC250	CBL-205323	
		220+ Converter	K-220+EPI-CNVTR	n/a
IGCA	n/a		K-EPI-000xxxxxx	n/a
(Generic/Domestic -Serial)				
EPI Grand (Top Mount)		Cable MC220+	CBL-900045	
		Cable MC250	CBL-205323	
		220+ Converter	K-220+EPI-CNVTR	n/a
IGCA	n/a		K-EPI-000xxxxxx	n/a
(Pulse)				
EPI Grand (Top Mount)		Cable MC220+	CBL-900010	
		220+ Converter	K-220+EPI-CNVTR	n/a
IGT	S+ Slant Top		K-EPI-300xxxxxx	K-DMK-205206-ZZ
3" Player Tracking				
		Cable MC220+	CBL-900045	
		Cable MC250	CBL-205323	
		Faceplate	P-105272	P-205221
		Overlay	M-R305275-YY	M-R305250-YY
		220+ Converter	K-220+EPI-CNVTR	n/a
IGT	S+ Slant Top		n/a	K-DMK-205171-ZZ
1.5" Sandwich Design				
		Cable MC220+	CBL-900045	
		Bracket	n/a	P-105124
		Faceplate	n/a	P-105185-ZZ
		Overlay	n/a	n/a



**EPI / DMK
Component Parts -
United States (cont.)**

Manufacturer	Model	Part Name	EPI	DMK
Description				
IGT	S+ Slant Top		n/a	K-DMK-205172-ZZ
Ramsey Design (IPT)				
		Cable MC220+	CBL-900045	
		Bracket	n/a	P-105131
		Faceplate	n/a	P-105170-ZZ
		Overlay	n/a	n/a
IGT	S+ Slant Top		K-EPI-304xxxxx	K-DMK-205353-ZZ
13" Top Box				
		Cable MC220+	CBL-900045	
		Cable MC250	CBL-205323	
		Faceplate	P-105298	P-105306-ZZ
		Overlay	M-R305378-YY	M-R305343-YY
		220+ Converter	K-220+EPI-CNVTR	n/a
IGT	S+ IBA		K-EPI-301xxxxx* *Replaced with 302	K-DMK-205207-ZZ
3" Player Tracking / Upright Casino Top				
		Cable MC220+	CBL-900045	
		Cable MC250	CBL-205323	
		Bracket	n/a	P-105209
		Faceplate	P-105266	P-205225-ZZ
		Overlay	M-R305271-YY	M-R305251-YY
		220+ Converter	K-220+EPI-CNVTR	n/a
IGT	S+ IBA / (older games)		K-EPI-306xxxxx	K-DMK-205142-ZZ
Narrow (2") Player Tracking / Upright - Casino Top				
		Cable MC220+	CBL-900045	
		Cable MC250	CBL-205323	
Requires Mounting Bracket		Bracket	n/a	P-105124
		Faceplate	P-105387	P-105186-ZZ
		Overlay	M-R305417-YY	n/a
		220+ Converter	K-220+EPI-CNVTR	n/a





**EPI / DMK
Component Parts -
United States (cont.)**

Manufacturer	Model	Part Name	EPI	DMK
Description				
IGT	S+ IBA / "I" Series		K-EPI-302xxxxxx	K-DMK-205208-ZZ
Upright				
		Cable MC220+	CBL-205310	
		Cable MC250	CBL-205506	
Requires Mounting Bracket		Bracket	P-105276	P-105211
		Faceplate	P-105352-02	P-205224-ZZ
		Overlay	M-R305396-YY	M-R305251-YY
		220+ Converter	K-220+EPI-CNVTR	n/a
IGT	S+ Round Top		K-EPI-305xxxxxx	K-DMK-205143-ZZ
(2") Tracking Ready (older games)				
		Cable MC220+	CBL-900045	
		Cable MC250	CBL-205323	
Requires Mounting Bracket		Bracket	P-105359	P-105154
		Faceplate	P-105360	P-105187-ZZ
		Overlay	M-R305274-YY	n/a
		220+ Converter	K-220+EPI-CNVTR	n/a
IGT	S+ Round Top		K-EPI-302xxxxxx	K-DMK-205208-ZZ
3" Player Tracking (newer games / post 10/97)				
		Cable MC220+	CBL-900045	
		Cable MC250	CBL-205323	
Requires Mounting Bracket		Bracket	P-105276	P-105211
		Faceplate	P-105352-02	P-205224-BK
		Overlay	M-R305396-YY	M-R305251-YY
		220+ Converter	K-220+EPI-CNVTR	n/a
IGT	PE+ w/ IMB B.A.		n/a	K-DMK-205141-ZZ
19.25" Top Glass, Player Tracking Ready				
		Cable MC220+	CBL-900045	
		Faceplate	n/a	P-105184-ZZ
		Overlay	n/a	M-R305252-YY
IGT	PE+ Slant Top		n/a	K-DMK-205171-ZZ
1.5" "Sandwich" Design				
		Cable MC220+	CBL-900045	
		Faceplate	n/a	P-105185-ZZ



**EPI / DMK
Component Parts -
United States (cont.)**

Manufacturer	Model	Part Name	EPI	DMK
Description				
IGT	PE+ w/ IMB B.A.		Black K-EPI-750xxxxxx Red K-EPI-780xxxxxx	K-DMK-205352-ZZ
Top Box (lock required)				
		Cable MC220+	CBL-900045	
		Cable MC250	CBL-205323	
		Faceplate	P-105252	P-105305-ZZ
		Overlay	M-R305266-YY	M-R305342-YY
		220+ Converter	K-220+EPI-CNVTR	n/a
IGT	PE+ Slant Top		K-EPI-300xxxxxx	K-DMK-205206-ZZ
3" Player Tracking				
		Cable MC220+	CBL-900045	
		Cable MC250	CBL-205323	
		Faceplate	P-105272	P-205221-ZZ
		Overlay	M-R305275-YY	M-R305250-YY
		220+ Converter	K-220+EPI-CNVTR	n/a
IGT	PE+ Slant Top		n/a	K-DMK-205172-ZZ
Ramsey Design (IPT)				
		Cable MC220+	CBL-900045	
		Bracket	n/a	P-105131
		Faceplate	n/a	P-105170-ZZ
IGT	PE+ Slant Top		K-EPI-304xxxxxx	K-DMK-205353-ZZ
13" Top Box (lock required)				
		Cable MC220+	CBL-205310	
		Cable MC250	CBL-205506	
		Bracket	n/a	P-105303
		Faceplate	P-105298	P-105306-ZZ
		Overlay	M-R305378-YY	M-R305343-YY
		220+ Converter	K-220+EPI-CNVTR	n/a
IGT	Game King Slant Top		n/a	K-DMK-205171-ZZ
1.5" "Sandwich" Design				
		Cable MC220+	CBL-205310	
		Faceplate	n/a	P-105185-ZZ
IGT	Game King Slant Top		n/a	K-DMK-205172-ZZ
Ramsey Design (IPT)				
		Cable MC220+	CBL-205310	
		Faceplate	n/a	P-105170-ZZ





**EPI / DMK
Component Parts -
United States (cont.)**

Manufacturer	Model	Part Name	EPI	DMK
Description				
IGT	Game King Slant Top	(No Speakers)	K-EPI-300xxxxxx	K-DMK-205206-ZZ
3" Player Tracking				
		Cable MC220+	CBL-205310	
		Cable MC250	CBL-205506	
		Faceplate	P-105272	P-105221-ZZ
		Overlay	M-R305275-YY	M-R305250-YY
		220+ Converter	K-220+EPI-CNVTR	n/a
IGT	13" Video Game King (Winners Choice)		n/a	K-DMK-205141-ZZ
Keypad Ready, in Top Glass, 1.5" Bracket				
		Cable MC220+	CBL-205310	
		Faceplate	n/a	P-105184-ZZ
		Overlay	n/a	M-R305352-YY
IGT	Game King Slant Top		K-EPI-304xxxxxx	K-DMK-205353-ZZ
13" Top Box (lock required)				
		Cable MC220+	CBL-205310	
		Cable MC250	CBL-205506	
		Bracket	n/a	P-105303
		Faceplate	P-105298	P-105306-ZZ
		Overlay	M-R305378-YY	M-R305343-YY
		220+ Converter	K-220+EPI-CNVTR	n/a
IGT	13" Game King (Winners Choice)		Black K-EPI-750xxxxxx Red K-EPI-780xxxxxx	K-DMK-205352-ZZ
Generic / Domestic Top Box Lock Required				
		Cable MC220+	CBL-205310	
		Cable MC250	CBL-205506	
		Faceplate	P-105252	P-105305-ZZ
		Overlay	M-R305266-YY	M-R305342-YY
		220+ Converter	K-220+EPI-CNVTR	n/a



**EPI / DMK
Component Parts -
United States (cont.)**

Manufacturer	Model	Part Name	EPI	DMK
Description				
IGT	Game King Upright	w/o ICONS	K-EPI-307020212	n/a
		4 x 3 Keypad with ICONS	K-EPI-307020213	
17" Monitor				
		Cable MC220+	CBL-205310	
		Cable MC250	CBL-205506	
		Overlay	M-R305427-01	n/a
Requires Mounting Bracket		Bracket	P-105427	n/a
		Faceplate	P-105426	n/a
		220+ Converter	K-220+EPI-CNVTR	n/a
IGT EZPay	Game King Upright	4 x 3 Keypad w/o ICONS	K-EPI-311020212	n/a
		17" Monitor		
		Cable MC220+	CBL-205310	
		Cable MC250	CBL-205506	
		Overlay	M-R305426-01	n/a
Requires Mounting Bracket		Bracket	P-105415	n/a
		Faceplate	P-105416	n/a
		220+ Converter	K-220+EPI-CNVTR	n/a
IGT	Twin Top Slant Top		n/a	K-DMK-205171-ZZ
1.5" Sandwich Bracket				
		Cable MC220+	CBL-900045	
		Faceplate	n/a	P-105157
IGT	19" Game King (Winners Choice)		K-EPI-302xxxxxx	K-DMK-205208-ZZ
		Cable MC220+	CBL-205310	
		Bracket	P-105276	P-105211
		Faceplate	P-105352-02	P-205224-ZZ
		Overlay	M-R305396-YY	M-R305251-YY
		220+ Converter	K-220+EPI-CNVTR	n/a
IGT	Dual Screen Keno		n/a	K-DMK-205289-ZZ
Upright				
		Cable MC220+	CBL-900045	
		Faceplate	n/a	P-105257-ZZ





**EPI / DMK
Component Parts -
United States (cont.)**

Manufacturer	Model	Part Name	EPI	DMK
Description				
IGT	19" Game King (Winners Choice)	With Ithaca Printer - SDG Format	K-EPI-308xxxxx	n/a
		Cable MC220+	CBL-205310	
Requires Mounting Bracket		Bracket	P-105412	n/a
		Faceplate	P-105411	n/a
		Overlay	M-R305418-01	n/a
		220+ Converter	K-220+EPI-CNVTR	n/a
IGT	Twin Top Slant Top		n/a	K-DMK-205177-ZZ
Ramsey Design (IPT)				
		Cable MC220+	CBL-900045	
		Faceplate	n/a	P-105170
IGT	Players Choice		n/a	K-DMK-205142-ZZ
Large Screen Classic				
		Cable MC220+	(To Be Determined)	
		Faceplate	n/a	P-105186-ZZ
IGT	All Models		n/a	K-DMKNEUM-COMP
Pulse Width Outputs				
		Cable MC220+	CBL-900010	
		Bracket	n/a	See specific model tables
		Faceplate	n/a	
		Overlay	n/a	
IGT	Vision Series	Lexus Oval Speakers	K-EPI-303xxxxx	n/a
Slant Top				
		Cable MC220+	CBL-205310	
		Cable MC250	CBL-205506	
		Faceplate	P-105330	n/a
		Overlay	M-R305381-YY	n/a
		220+ Converter	K-220+EPI-CNVTR	n/a
IGT	Vision Series		K-EPI-302xxxxx	K-DMK-205208-05
Upright Square Top				
		Cable MC220+	CBL-205310	
		Cable MC250	CBL-205506	
Requires Mounting Bracket		Bracket	P-105276	P-105211
		Faceplate	P-105352-02	P-205224-ZZ
		Overlay	M-R305396-YY	M-R305251-YY
		220+ Converter	K-220+EPI-CNVTR	n/a



**EPI / DMK
Component Parts -
United States (cont.)**

Manufacturer	Model	Part Name	EPI	DMK
Description				
IGT	Vision Series	With Ithaca Printer - SDG Format	K-EPI-309xxxxxx	n/a
Slant Top				
		Cable MC220+	CBL-205310	
		Cable MC250	CBL-205506	
		Faceplate	P-105410	n/a
		Overlay	M-R305381-YY	n/a
		220+ Converter	K-220+EPI-CNVTR	n/a
IGT	Vision Series		K-EPI-302xxxxxx	K-DMK-205208-ZZ
Upright Round Top				
		Cable MC220+	CBL-205310	
		Cable MC250	CBL-205506	
Requires Mounting Bracket		Bracket	P-105276	P-105211-ZZ
		Faceplate	P-105352-02	P-205224-BK
		Overlay	M-R305396-YY	M-R305396-YY
		220+ Converter	K-220+EPI-CNVTR	n/a
IGT	Vision Series	EZ Pay	K-EPI-312xxxxxx	n/a
S2000				
		Cable MC220+	CBL-205310	
		Cable MC250	CBL-205506	
Requires Mounting Bracket		Bracket	P-105429	n/a
		Faceplate	P-105430	n/a
		Overlay	M-R305432-01	n/a
		220+ Converter	K-220+EPI-CNVTR	n/a
IGT	Older Games		K-EPI-356xxxxxx	K-DMK-205445-05
4" - Deep Slant Top				
		Cable MC220+	CBL-900045	
		Cable MC250	CBL-205323	
		Faceplate	P-105317-ZZ	P-105342-05 P-105303
		Overlay	M-R305387-YY	M-R305388-YY
		220+ Converter	K-220+EPI-CNVTR	n/a
IGT	S+ Jeopardy		K-EPI-302xxxxxx	K-DMK-205208-ZZ
Upright Round Top				
		Cable MC220+	CBL-205310	
		Cable MC250	CBL-205506	
Requires Mounting Bracket		Bracket	P-105276	P-105211
		Faceplate	P-105352-02	P-205224-ZZ
		Overlay	M-R305396-YY	M-R305251-YY
		220+ Converter	K-220+EPI-CNVTR	n/a





**EPI / DMK
Component Parts -
United States (cont.)**

Manufacturer	Model	Part Name	EPI	DMK
Description				
IGT	S+ Wheel Of Fortune		K-EPI-302xxxxxx	K-DMK-205208-05
Upright Round Top (3")				
		Cable MC220+	CBL-900045	
		Cable MC250	CBL-205323	
Requires Mounting Bracket		Bracket	P-105276	P-105211-ZZ
		Faceplate	P-105352-02	P-205224-ZZ
		Overlay	M-R305396-YY	M-R305251-YY
		220+ Converter	K-220+EPI-CNVTR	n/a
IGT	S+ "I" Wheel Of Fortune		K-EPI-303xxxxxx	n/a
5¢ Slant Top Wide Area Progressive				
		Cable MC220+	CBL-205310	
		Cable MC250	CBL-205506	
Requires Mounting Bracket		Bracket	P-105158	n/a
		Faceplate	P-105330	n/a
		Overlay	M-R305381-YY	n/a
		220+ Converter	K-220+EPI-CNVTR	n/a
IGT	S+ Wheel Of Fortune		K-EPI-305xxxxxx	K-DMK-205143-05
Upright Round Top (1.5")				
		Cable MC220+	CBL-900045	
		Cable MC250	CBL-205323	
Requires Mounting Bracket		Bracket	P-105359	P-105154-ZZ
		Faceplate	P-105360	P-105187-05
		Overlay	M-R305274-YY	n/a
		220+ Converter	K-220+EPI-CNVTR	n/a
IGT	GameKing Plus		K-EPI-314xxxxxx	n/a
19.5" Upright				
		Cable MC220+	n/a	
		Cable MC250	CBL-205506	
Requires Mounting Bracket		Bracket	P-105435	n/a
		Faceplate	P-105436	n/a
		Overlay	M-R305435-01	n/a
Konami	n/a		K-EPI-000020212	n/a
4 x 3 keypad				
		Cable MC220+	n/a	
		Cable MC250	CBL-205575	



**EPI / DMK
Component Parts -
United States (cont.)**

Manufacturer	Model	Part Name	EPI	DMK
Description				
Shufflemaster	n/a		K-EPI-000xxxxxx	n/a
		Cable MC220+	n/a	
		Cable MC250	CBL-205323	
		220+ Converter	n/a	n/a
Sigma	SG150 SG300	ie: Yahtzee	K-EPI-000xxxxxx	K-DMKNEUIM-COMP
Upright Reel w/ SIB Board (Serial)				
		Overlay	M-R305380-yy	n/a
		Cable MC220+	CBL-205379	
		Cable MC250	CBL-205522	
		220+ Converter	K-220+EPI-CNVTR	n/a
Sigma	PT2, PT4, SG32, SG50		n/a	n/a
(clock / data)				
		Cable MC220+	CBL-900023	
Sigma	SG1, SG111, SG112		n/a	K-DMKNEU-SIG
(clock / data)				
		Cable MC220+	CBL-900023	
		Piggyback Board	AS-906518	
Silicon Gaming	n/a		K-EPI-000xxxxxx	K-DMKNEUIM-COMP
Generic / Domestic				
		Cable MC220+	CBL-900045	
		Cable MC250	CBL-205323	
		220+ Converter	K-220+EPI-CNVTR	n/a
Summit Limited	n/a		K-EPI-000xxxxxx	n/a
		Cable MC220+	n/a	
		Cable MC250	CBL-205323	
		220+ Converter	n/a	n/a
Universal	n/a		n/a	n/a
Simple Serial		To Be Determined		





**EPI / DMK
Component Parts -
United States (cont.)**

Manufacturer	Model	Part Name	EPI	DMK
Description				
Universal	n/a		K-EPI-000xxxxxx	K-DMKNEUIM-COMP
(clock / data)				
		Cable	n/a	
		Piggyback Board	AS-906474	
		220+ Converter	K-220+EPI-CNVTR	n/a
Unidesa	n/a		K-EPI-000xxxxxx	n/a
Simple Serial				
		Cable MC220+	CBL-900045	
		Cable MC250	CBL-205323	
		220+ Converter	K-220+EPI-CNVTR	n/a
US Games	n/a		K-EPI-000xxxxxx	n/a
Video Poker				
		Cable MC220+	CBL-205202	
Leisure Time Gaming - Pot of Gold		Cable MC250	CBL-205573	
		220+ Converter	K-220+EPI-CNVTR	n/a
VLC	n/a		K-EPI-000xxxxxx	K-DMKNEUIM-COMP
n/a				
		Cable MC220+	CBL-205211	
		Cable MC250	CBL-205538	
		220+ Converter	K-220+EPI-CNVTR	n/a
WILLIAMS	Upright / Wide Body / Slant		K-EPI-000xxxxxx	K-DMKNEUIM-COMP
All Models / Simple Serial				
		Cable MC220+	CBL-205161	
		Cable MC250	CBL-205515	
Upright / Wide Body Slant Top		Overlay	M-R305303-YY	n/a
			M-R305302-YY	n/a
		220+ Converter	K-220+EPI-CNVTR	n/a
World Touch Gaming	n/a		K-EPI-000xxxxxx	n/a
		Cable MC220+	n/a	
		Cable MC250	CBL-205323	
		220+ Converter	n/a	n/a



**EPI / DMK
Component
Parts -
International**

Manufacturer	Model	Part Name	EPI	DMK
Description				
Coinmaster	n/a		K-EPI-000xxxxxx	n/a
U.K				
		Cable MC220+	n/a	
		Cable MC250	CBL-205323	
		220+ Converter	n/a	n/a
Pacific Gaming	n/a		K-EPI-000xxxxxx	n/a
Australia				
		Cable MC220+	n/a	
		Cable MC250	CBL-205323	
		220+ Converter	n/a	n/a
R. Franco	n/a		K-EPI-000xxxxxx	n/a
Spain				
		Cable MC220+	n/a	
		Cable MC250	CBL-205323	
		220+ Converter	n/a	n/a
Spielo Gaming	n/a		K-EPI-000xxxxxx	n/a
Canada				
		Cable MC220+	n/a	
		Cable MC250	CBL-205323	
		220+ Converter	n/a	n/a

**SDS Kits -
230V power
supply kits for
Riverboats**

SDS KITS - PRODUCT REFERENCE LIST - Domestic 230V kits						
Machine Manufacturer	Model	Description	Mastercomm/ GMU	EPI Reader ID #	DMK Reader ID #	Notes
Bally	S5500	n/a	KS-250-BAL-S55	K-EPI-000xxxxxx	n/a	Mfr. supplies metal work
Bally	V7000	n/a	KS-250-BAL-V7K	K-EPI-000xxxxxx	n/a	Mfr. supplies metal work
IGT	Game King	n/a	KS-250-GAMEKING	Reference the United States Kits for these part numbers		
IGT	n/a	n/a	KS-250-SMPL-SER	Reference the United States Kits for these part numbers		





SDS Kits - Germany

SDS KITS - PRODUCT REFERENCE LIST - GERMANY							
Machine Manufacturer	Model	Description	Cable	Mastercomm/ GMU	EPI Reader ID #	DMK Reader ID #	Notes
Atronics	n/a	Generic / Domestic	CBL-900045	G-220+SIMPL-SER	K-EPI-000xxxxxx	n/a	Mfr. supplies metal work
Aristocrat	n/a	European Games / Direct Input	CBL-205233	G-220+ARISTO	K-EPI-000xxxxxx	K-DMKNEUIM-COMP	Mfr. supplies metal work
Bally	S5500	European Specific Code	CBL-900045	G-220+BAL-S5500	K-EPI-000xxxxxx	K-DMKNEUIM-COMP	
				G-250-BAL-S5500	K-EPI-000xxxxxx	n/a	
Bally	V7000	European Specific Code	CBL-205130	G-220+BAL-V7000	K-EPI-000xxxxxx	K-DMKNEUIM-COMP	
				G-250-BAL-V7000	K-EPI-000xxxxxx	n/a	
CDS	n/a	Generic / European	CBL-900045	G-220+SIMPL-SER	K-EPI-000xxxxxx	n/a	Mfr. supplies metal work
IGCA	n/a	Generic / European	CBL-900045	G-220+SIMPL-SER	K-EPI-000xxxxxx	n/a	Mfr. supplies metal work
IGT	n/a	Generic / European		G-220+SIMPL-SER	Reference the United States Kits for these numbers		
IGT	Game-King	Generic/ European		G-250-GAMEKING	K-EPI-000xxxxxx	n/a	
Sigma	n/a	European Games	CBL-900023	G-220+SIGMA	K-EPI-000xxxxxx	n/a	Mfr. supplies metal work
Silicon Gaming	n/a	Generic / European	CBL-900023	G-220+SIMPL-SER	K-EPI-000xxxxxx	K-DMKNEU-COMP	Mfr. supplies metal work
Williams	n/a	European Games		G-250-WILLIAMS	K-EPI-000xxxxxx	n/a	

NOTE: Kits for Germany require 220VAC power supplies.



SDS Kits - New Zealand

SDS KITS - PRODUCT REFERENCE LIST - NEW ZEALAND						
Machine Manufacturer	Model	Description	Mastercomm/ GMU	EPI Reader ID #	DMK Reader ID #	Notes
Aristocrat	n/a	n/a	N-220+ARIS-SER	K-EPI-000xxxxxx	n/a	Mfr. supplies metal work
Aristocrat	Slant Top	n/a	N-220+ARIS-SLTP	K-EPI-000xxxxxx	n/a	Mfr. supplies metal work
IGT	n/a	n/a	N-220+IGT-SER	Reference the United States Kits for these part numbers		BGS supplies metal work